

Clevis & Eye Rigging Screws

Product Description

- AS2319-2001
- 6:1 Safety Factor
- Grades L, P & S
- Testing and Certification
- Galvanized
- Manufactured using only heat certified Australian Steel (AS1442/AS1444)



Available on Request

- Lock Nuts

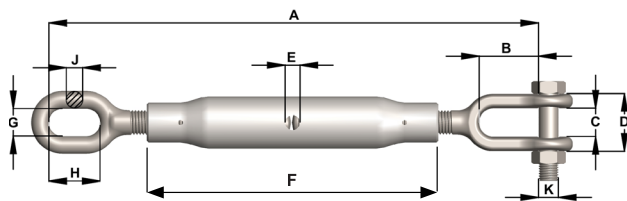

Townley Drop Forge is both NATA Accredited (Test Lab No. 13554) and AS/NZS ISO9001 Certified (Certificate number FS 604897)..

Dimensions and Working Load Limits (WLL) Metric - Grades L , P & S

Nominal Size	A Closed	A Open	B	C	D	E	F	G	H	J	K	Grade L WLL	Grade P WLL	Grade S WLL
M10	260	385	30	14	30	8.5	180	11	21	7	10	0.3t	0.6t	0.8t
M12	335	525	36	15	35	8.5	230	14	30	9	10	0.5t	1t	1.2t
M16	355	535	45	20	40	9.0	230	17	36	12	12	0.75t	1.6t	2t
M20	385	550	55	22	46	10.5	230	21	42	14	16	1.25t	2.5t	3.2t
M24	555	735	59	30	58	13.0	360	25	51	17	20	2.5t	4t	5t
M33	641	902	76.5	38	76	14	380	34	70	25	27	5t	8t	10t
M39	678	939	92	51	97	14	410	40	80	28	30	6t	10t	12t
M42	734	975	114	55	115	18	410	45	90	30	36	7.5t	12t	16t
M48	732	993	111	55	115	18	410	49	98	33	42	10t	16t	20t

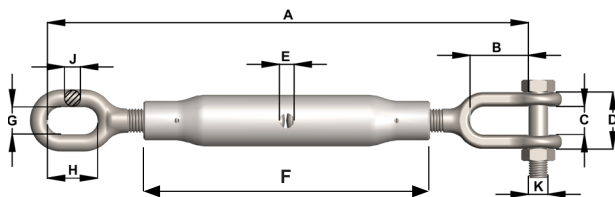

Dimensions and Working Load Limits (WLL) BSW – Grade L

Nominal Size	A Closed	A Open	B	C	E	F	G	H	J	K	Grade L WLL
1 1/4"	603	876	63	38	14	380	35	65	22	25	5t
1 1/2"	673	952	82	48	16	405	38	75	25	32	6t
1 3/4"	705	959	93	50	17	405	41	88	32	35	7.5t
2"	743	978	99	50	19	405	44	102	38	41	10t
2 1/4"	813	1029	115	60	22	405	60	130	41	47	15t
2 1/2"	826	1029	115	70	22	405	60	130	47	51	20t

Subject to technical modifications