

Eye & Eye Rigging Screws

Product Description

- AS2319-2001
- 6:1 Safety Factor
- Grades L, P & S
- Testing and Certification
- Galvanized
- Manufactured using only heat certified Australian Steel (AS1442/AS1444)



Available on Request

- Lock Nuts

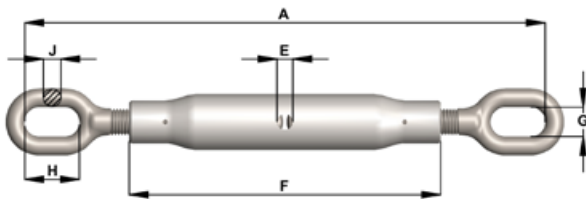

Townley Drop Forge is both NATA Accredited (Test Lab No. 13554) and AS/NZS ISO9001 Certified (Certificate number FS 604897)..

Dimensions and Working Load Limits (WLL) Metric - Grades L, P & S

Nominal Size	A Closed	A Open	E	F	G	H	J	Grade L WLL	Grade P WLL	Grade S WLL
M10	260	380	8.5	180	12	21	7	0.3t	0.6t	0.8t
M12	340	520	8.5	230	15	30	9	0.5t	1t	1.2t
M16	350	525	9.0	230	17	36	12	0.75t	1.6t	2t
M20	380	545	10.5	230	21	42	12	1.25t	2.5t	3.2t
M24	540	725	13.0	360	25	51	17	2.5t	4t	5t
M33	656	932	14	380	34	70	24.5	5t	8t	10t
M39	664	952	14	410	40	80	28	6t	10t	12t
M42	695	975	18	410	45	90	30	7.5t	12t	16t
M48	734	995	18	410	49	98	33	10t	16t	20t

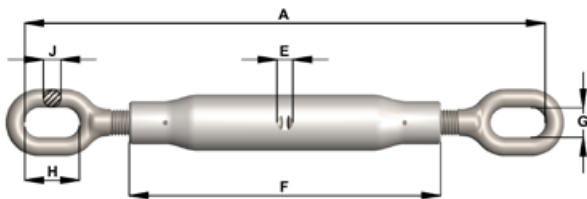

Dimensions and Working Load Limits (WLL) BSW – Grade L

Nominal Size	A Closed	A Open	E	F	G	H	J	Grade L WLL
1 1/4"	590	837	14	380	35	65	22	5t
1 1/2"	648	927	16	405	38	75	25	6t
1 3/4"	686	946	17	405	41	88	32	7.5t
2"	717	965	19	405	44	102	38	10t
2 1/4"	813	1016	22	405	60	130	41	15t
2 1/2"	813	1016	22	405	60	130	47	20t

Subject to technical modifications