

# Clevis & Clevis Rigging Screws

## Product Description

- AS2319-2001
- 6:1 Safety Factor
- Grades L, P & S
- Fully Tested and Certified to AS2319
- Galvanized
- Manufactured using only heat certified Australian Steel (AS1442/AS1444)



### Available on Request

- Lock Nuts

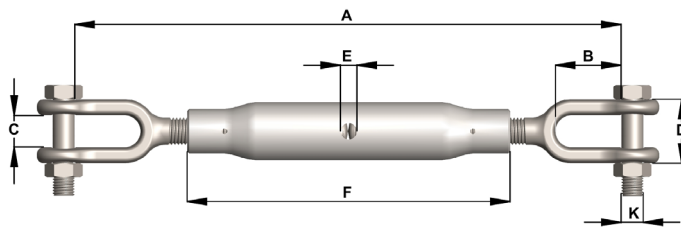

Townley Drop Forge is both NATA Accredited (Test Lab No. 13554) and AS/NZS ISO9001 Certified (Certificate number FS 604897).

### Dimensions and Working Load Limits (WLL) Metric - Grades L, P & S

Nominal Size	A Closed	A Open	B	C	D	E	F	K	Grade L WLL	Grade P WLL	Grade S WLL
M10	265	395	30	14	30	8.5	180	10	0.3t	0.6t	0.8t
M12	340	525	36	15	35	8.5	230	10	0.5t	1t	1.2t
M16	360	535	45	20	40	9	230	12	0.75t	1.6t	2t
M20	390	555	55	22	46	10.5	230	16	1.25t	2.5t	3.2t
M24	555	740	59	30	58	13	360	20	2.5t	4t	5t
M33	628	904	80	38	75	14	380	27	5t	8t	10t
M42	690	890	93	50	110	17	405	35	7.5t	12t	16t
M48	755	989	109	54	110	18	420	42	10t	16t	20t
M64	740	960	105	70	152	22	410	56	20t	28t	36t

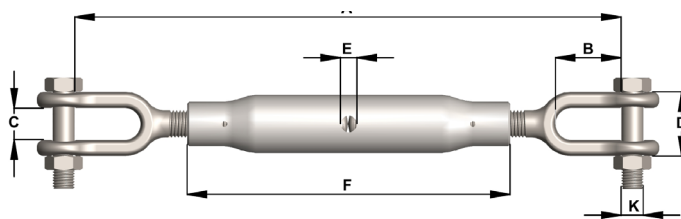

### Dimensions and Working Load Limits (WLL) BSW - Grade L

Nominal Size	A Closed	A Open	B	C	E	F	K	Grade L WLL
1 1/4"	610	830	63	38	14	380	25	5t
1 1/2"	660	920	82	48	16	405	32	6t
1 3/4"	690	890	93	50	17	405	35	7.5t
2"	762	997	99	50	19	405	41	10t
2 1/4"	819	1029	115	60	22	405	47	15t
2 1/2"	838	1035	115	70	22	405	51	20t

Subject to technical modifications