

# Closed Wedge Sockets

## Product Description

- Manufactured in Australia
- Cast Alloy Steel
- Available for rope sizes 6mm to 20mm
- 100% Magnetic particle inspected in accordance with AS1171
- Ultrasonically tested in accordance with AS2574

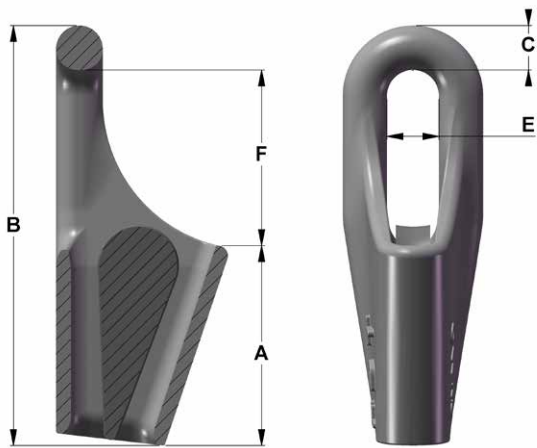

### Surface finish options include:

- Black self colour
- Zinc plated
- Galvanized
- Painted



Rope Diameter	A	B	C	E	F	Weight (kg)	Product code
6	41	90	13	12	40	0.3	FDT-CW06
10	61	127	15	17	51	0.6	FDT-CW10
13	75	165	19	21	71	1.2	FDT-CW13
16	86	220	21	44	111	2	FDT-CW16
20	100	245	25	36	116	4.2	FDT-CW20