

Clevis & Clevis Rigging Screws

Product Description

- AS2319-2001
- 6:1 Safety Factor
- Grades L, P & S
- Testing and Certification
- Galvanized
- Manufactured using only heat certified Australian Steel (AS1442/AS1444)



Available on Request

- Lock Nuts

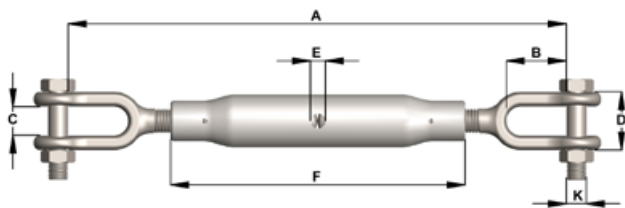

Townley Drop Forge maintains a NATA Accredited Laboratory (Test Lab No. 13554) and an AS/NZS ISO9001 Certified QMS (Certificate number FS 604897)

Dimensions and Working Load Limits (WLL) Metric - Grades L, P & S

Nominal Size	A Closed	A Open	B	C	D	E	F	K	Grade L WLL	Grade P WLL	Grade S WLL
M10	265	395	30	14	30	8.5	180	10	0.3t	0.6t	0.8t
M12	340	525	36	15	35	8.5	230	10	0.5t	1t	1.2t
M16	360	535	45	20	40	9	230	12	0.75t	1.6t	2t
M20	390	555	55	22	46	10.5	230	16	1.25t	2.5t	3.2t
M24	555	740	59	30	58	13	360	20	2.5t	4t	5t
M33	628	902	76.5	38	76	14	380	27	5t	8t	10t
M39	692	980	92	51	97	14	410	30	6t	10t	12t
M42	733	1013	114	55	115	18	410	36	7.5t	12t	16t
M48	730	991	111	55	115	18	410	42	10t	16t	20t
M64	744	957	105	72.5	156	25	410	56	20t	28t	36t

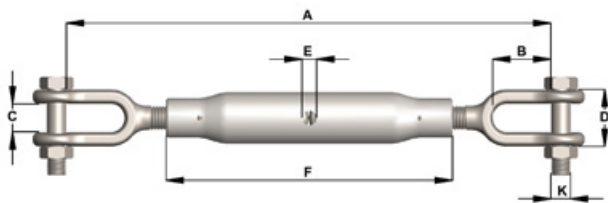

Dimensions and Working Load Limits (WLL) BSW – Grade L

Nominal Size	A Closed	A Open	B	C	E	F	K	Grade L WLL
1 1/4"	610	830	63	38	14	380	25	5t
1 1/2"	660	920	82	48	16	405	32	6t
1 3/4"	690	890	93	50	17	405	35	7.5t
2"	762	997	99	50	19	405	41	10t
2 1/4"	819	1029	115	60	22	405	47	15t
2 1/2"	838	1035	115	70	22	405	51	20t

Subject to technical modifications